

**U.S. General**®

# 4 DRAWER 580 LB. ROLL CART

**Model 95659**

## ASSEMBLY AND OPERATION INSTRUCTIONS



Diagrams within this manual may not be drawn proportionally.  
Due to continuing improvements, actual product may differ slightly from the product described herein.

**Distributed exclusively by Harbor Freight Tools®.**

3491 Mission Oaks Blvd., Camarillo, CA 93011

Visit our website at: <http://www.harborfreight.com>



**Read this material before using this product.  
Failure to do so can result in serious injury.  
SAVE THIS MANUAL.**

Copyright© 2007 by Harbor Freight Tools®. All rights reserved. No portion of this manual or any artwork contained herein may be reproduced in any shape or form without the express written consent of Harbor Freight Tools.

**For technical questions or replacement parts, please call 1-800-444-3353.**

Revised cover page 08e

---

## SPECIFICATIONS

---

Maximum Weight Capacity	580 Lbs. overall; Top Tray: 200 Lbs. 2 Small Drawers: 30 Lbs. each Medium Drawer: 50 Lbs. Bottom Drawer: 70 Lbs. Bottom Tray: 200 Lbs.
Overall Dimensions	33-1/2" Long x 17-1/2" Deep x 38-1/4" High
Handle	16-1/8" L x 1-1/4" diameter
Inside Lid Compartment Dimensions	27" L x 15-1/2" Deep x 2" Deep
Small Drawer Dimension	12-1/4" W x 14-1/2" Deep x 2" Deep
Middle Drawer Dimension	26-3/4" x 14-1/2" Deep x 2-3/4" Deep
Bottom Drawer Dimension	26" W x 14-1/2" Deep x 4" Deep
Net Weight	95 Lbs.
Bottom Shelf Dimension	30-1/4" Wide x 16" Deep x 3" Deep
Caster Dimension	5-1/4" diameter x 1-1/8" Wide (2) Locking, (2) Swivel
Provides over 5,500 cubic inches of storage space. Heavy duty all steel construction with powder coated handle and ball bearing slides for smooth drawer movement.	

### Save This Manual

You will need this manual for the safety warnings and precautions, assembly, operating, inspection, maintenance and cleaning procedures, parts list and assembly diagram. Keep your invoice with this manual. Keep this manual and invoice in a safe and dry place for future reference.

---

## GENERAL SAFETY RULES

---



**READ AND UNDERSTAND ALL INSTRUCTIONS**  
**Failure to follow all instructions listed below may result in**  
**serious injury.**  
**SAVE THESE INSTRUCTIONS**

1. **Keep your work area clean and well lit.** Cluttered benches and dark areas invite accidents.
2. **Keep bystanders, children, and visitors away.** Distractions can cause you to lose control. Keep children out of the work area; do not allow them to climb or sit on the Roll Cart.
3. **Stay alert. Watch what you are doing and use common sense during assembly and use of this product.**

4. **During assembly dress properly. Do not wear loose clothing or jewelry. Contain long hair.**
5. **Do not overreach. Keep proper footing and balance at all times.**
6. **Use safety equipment during assembly. Always wear eye protection.** Always wear ANSI-approved safety goggles when assembling the Roll Cart.
7. **Do not force the product. Use the correct product for your application.** The correct product will do the job better and safer at the rate for which it is designed. Do not force the product and do not use it for a purpose for which it is not intended.
8. **Store an idle Roll Cart out of reach of children and other untrained persons.**
9. **Use only accessories that are recommended by the manufacturer for your model.** Accessories that may be suitable for one product may become hazardous when used on another product.
10. **Maintain labels and nameplates on the Roll Cart.** These carry important information. If unreadable or missing, contact Harbor Freight Tools for a replacement.
11. **Maintain a safe working environment.** Make sure there is adequate surrounding workspace. Do not use this product in a damp or wet location.
12. **Make certain Caster Wheels are locked in position when the Roll Cart is stationary.**
13. **Do not exceed the maximum weight capacity of 580 Lbs.** for the entire Roll Cart. Do not exceed the maximum weight capacity for each individual Drawer and Tray.
14. **Use on a flat, level surface capable of supporting the Roll Cart and the products within it.**
15. **Keep the lid and all drawers on this Roll Cart closed and locked when not in use.** This prevents children from opening any of the drawers and prevents misuse of any tools stored within. Keep keys in a safe location out of the reach of children.
16. **Load tools evenly.** As much as possible, distribute the weight of all tools stored in this Roll Cart evenly.
17. **Do not use this Roll Cart as a stepping stool or ladder.** Never sit, stand, or climb on this Roll Cart.
18. **Avoid tipping; do not overload or over-stack this Roll Cart.** Overloading can damage drawers and casters and could possibly result in tipping and personal injury. Over-stacking can result in tools or other objects sliding or falling from the Roll Cart and could result in damaged tools and/or personal injury.
19. **Be aware of dynamic loading! Dropping or bouncing a load may briefly create excess load causing product damage, severe personal injury, and/or death.**

**Note: Please note the number on the key and store it in a safe place. This number may also be on the lock. It will be needed if extra keys are ordered.**

---

## **ASSEMBLY INSTRUCTIONS**

---

**Note:** For additional information regarding the parts listed in the following pages, refer to the Assembly Diagram on page 6.

1. Attach two Locking Casters (10) and two Swivel Casters (12) to the Bottom Tray (11). Use four Bolts (13), four Spring Washers (3), and four Nuts (4) per caster as shown in Figure 1 below.

**Figure 1**

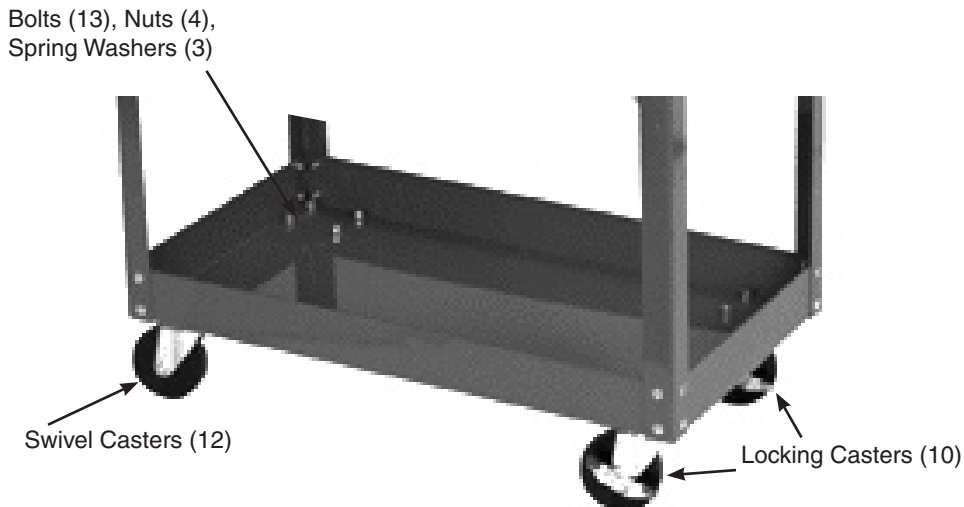

2. Connect both Right Leg Posts (1) to each other with one Support Frame (9) attached at the center with two Ball Type Bolts (2), two Nuts (4) and two Spring Washers (3). Repeat same assembly for both Left Leg Posts (6).
3. Attach the Bottom Tray (11) to both Left Leg Posts (6) using eight Ball Type Bolts (2), eight Nuts (4) and eight Spring Washers (3).
4. Attach the bottom of the Right Leg Posts (1) to the Bottom Tray (11) using eight Ball Type Bolts (2), eight Nuts (4) and eight Spring Washers (3).
5. Attach both Right Leg Posts (1) to the Upper Tray/Drawer Unit (5) using eight Ball Type Bolts (2), eight Nuts (4) and eight Spring Washers (3).
6. Attach both Left Leg Posts (6) to the Upper Tray/Drawer Unit (5) using six Ball Type Bolts (2), six Nuts (4) and six Spring Washers (3).
7. Attach the Push Handle (7) to the two Left Leg Posts (6) and the Upper Tray/Drawer Unit (5) using two Ball Type Bolts (8), two Nuts (4) and two Spring Washers (3).
8. Tighten all hardware.

9. Check the Roll Cart to make certain that it sits evenly and that all hardware is squarely set. Make certain all drawers slide properly, that all locks work, and that Casters roll smoothly and evenly.

---

## **OPERATING INSTRUCTIONS**

---

1. Set the Roll Cart up in the desired location.
2. Make certain to set both Locking Casters (10) once the Roll Cart is in place. To set the brake, pull up on the tab located on each Locking Caster (10).
3. Fill each of the drawers and trays as desired. Do not exceed the maximum weight capacity of 580 lbs. for the Roll Cart and the maximum weight capacity for each drawer and tray as follows: Top Tray: 200 Lbs., 2 Small Drawers: 30 Lbs. each, Medium Drawer: 50 Lbs. Bottom Drawer: 70 Lbs. and Bottom Tray: 200 Lbs.

---

## **INSPECTION, MAINTENANCE, AND CLEANING**

---

1. Clean the Roll Cart with a damp cloth. Do not use abrasives, harsh chemicals or detergents as these will scratch and damage the Bins and frame.
2. **BEFORE EACH USE**, inspect the general condition of the Roll Cart. Check for loose screws, misalignment or binding of moving parts, cracked or broken parts and any other condition that may affect its safe operation. **Do not use damaged equipment.**

## PARTS LIST AND ASSEMBLY DIAGRAM

Part	Description	Q'ty	Part	Description	Q'ty
1	Right Leg Post	2	8	Ball Type Bolts M8 x 16	2
2	Ball Type Bolts M8 x 12	34	9	Support Frame	2
3	Spring Washer	52	10	Locking Caster	2
4	Nut	52	11	Bottom Tray	1
5	Upper Tray/Drawer Unit	1	12	Swivel Caster	2
6	Left Leg Post	1	13	Bolts M8 x 16	16
7	Push Handle	1	14	Cap	2

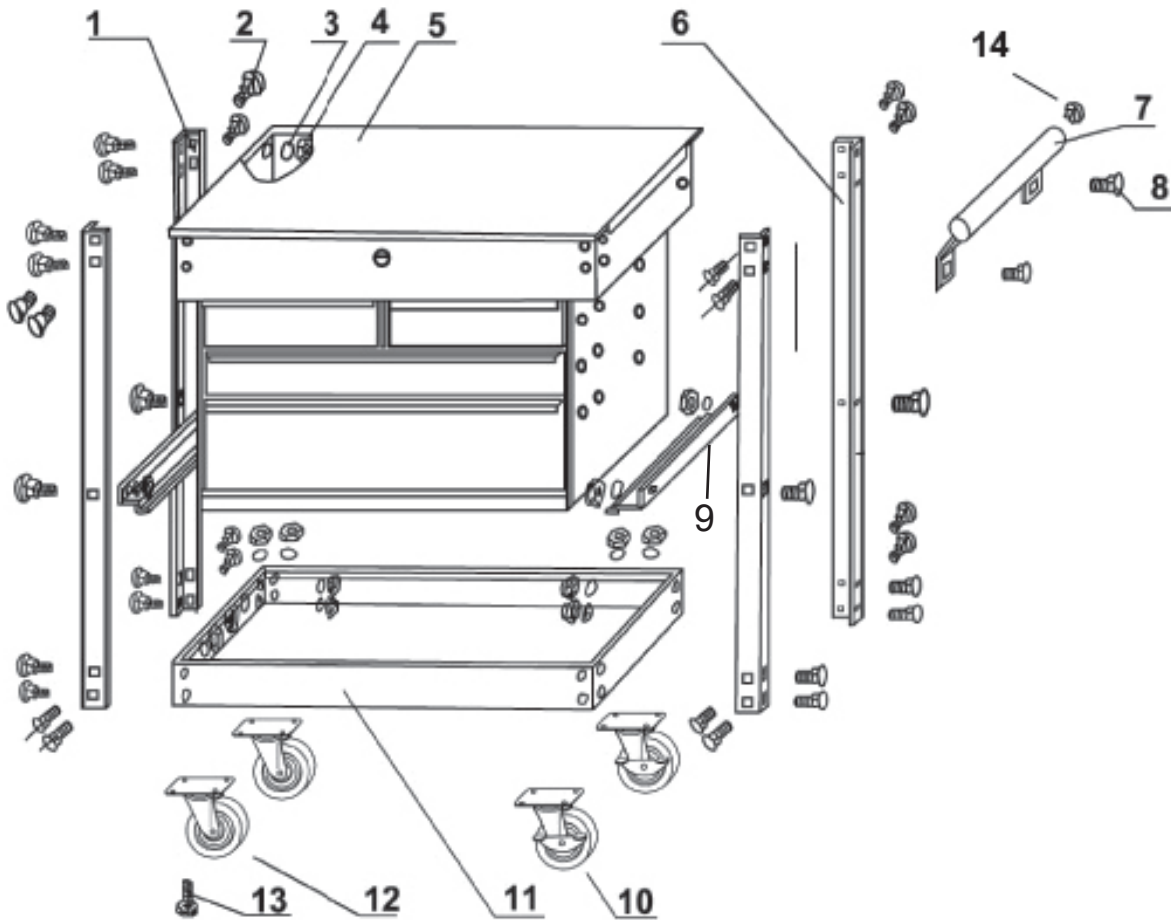

---

## LIMITED 90 DAY WARRANTY

---

Harbor Freight Tools Co. makes every effort to assure that its products meet high quality and durability standards, and warrants to the original purchaser that this product is free from defects in materials and workmanship for the period of 90 days from the date of purchase. This warranty does not apply to damage due directly or indirectly, to misuse, abuse, negligence or accidents, repairs or alterations outside our facilities, criminal activity, improper installation, normal wear and tear, or to lack of maintenance. We shall in no event be liable for death, injuries to persons or property, or for incidental, contingent, special or consequential damages arising from the use of our product. Some states do not allow the exclusion or limitation of incidental or consequential damages, so the above limitation of exclusion may not apply to you. THIS WARRANTY IS EXPRESSLY IN LIEU OF ALL OTHER WARRANTIES, EXPRESS OR IMPLIED, INCLUDING THE WARRANTIES OF MERCHANTABILITY AND FITNESS.

To take advantage of this warranty, the product or part must be returned to us with transportation charges prepaid. Proof of purchase date and an explanation of the complaint must accompany the merchandise. If our inspection verifies the defect, we will either repair or replace the product at our election or we may elect to refund the purchase price if we cannot readily and quickly provide you with a replacement. We will return repaired products at our expense, but if we determine there is no defect, or that the defect resulted from causes not within the scope of our warranty, then you must bear the cost of returning the product.

This warranty gives you specific legal rights and you may also have other rights which vary from state to state.

3491 Mission Oaks Blvd. • PO Box 6009 • Camarillo, CA 93011 • (800) 444-3353

---

## PLEASE READ THE FOLLOWING CAREFULLY

---

THE MANUFACTURER AND/OR DISTRIBUTOR HAS PROVIDED THE PARTS LIST AND ASSEMBLY DIAGRAM IN THIS MANUAL AS A REFERENCE TOOL ONLY. NEITHER THE MANUFACTURER OR DISTRIBUTOR MAKES ANY REPRESENTATION OR WARRANTY OF ANY KIND TO THE BUYER THAT HE OR SHE IS QUALIFIED TO MAKE ANY REPAIRS TO THE PRODUCT, OR THAT HE OR SHE IS QUALIFIED TO REPLACE ANY PARTS OF THE PRODUCT. IN FACT, THE MANUFACTURER AND/OR DISTRIBUTOR EXPRESSLY STATES THAT ALL REPAIRS AND PARTS REPLACEMENTS SHOULD BE UNDERTAKEN BY CERTIFIED AND LICENSED TECHNICIANS, AND NOT BY THE BUYER. THE BUYER ASSUMES ALL RISK AND LIABILITY ARISING OUT OF HIS OR HER REPAIRS TO THE ORIGINAL PRODUCT OR REPLACEMENT PARTS THERETO, OR ARISING OUT OF HIS OR HER INSTALLATION OF REPLACEMENT PARTS THERETO.